

# TECHNICAL DATASHEET

## LC-366 Passive Infrared SenSwitch

### INTRODUCTION

IR-TEC LC-366 is a multipurpose Passive Infrared SenSwitch for automatic operation control of light, motor or other devices, by detecting the motion of human body within its detection range. The LC-366 employs a dual element pyroelectric infrared sensor and advanced electronics circuit to provide following outstanding features for diverse control of OEM applications.

- Available for resistive/inductive load control.
- Up to 5m dia. detection range.
- 50% detection range cover provided.
- Adjustable light hold-on delay time.
- Adjustable light switching LUX level.
- Overload fuse protection built-in.
- Horizontal/vertical mounting option.

### APPLICATIONS

IR-TEC LC-366 Passive Infrared SenSwitch is ideal to control the device that requires automatic operation followed the presence of user. Its typical applications include,

- Ceiling mount light fixture
- Wall mount light fixture
- Bathroom/toilet ventilator
- Indoor air quality filter

### CONNECTIONS

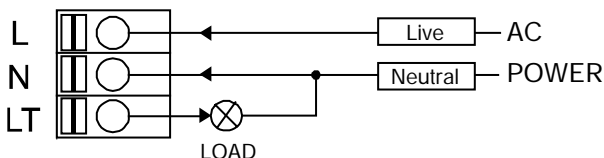

### WIRING NOTES

- Wire specification: AWG 16~20.
- The wires should be solid or tined strand.
- Proper strip length: 7.0 ~ 8.5 mm.

### APPEARANCE

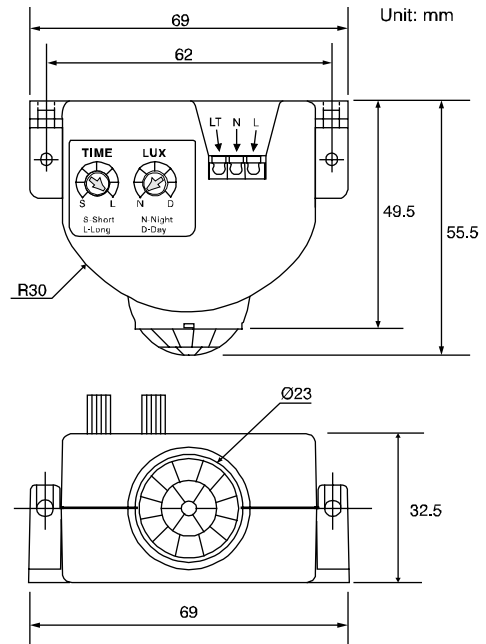

### DETECTION RANGE

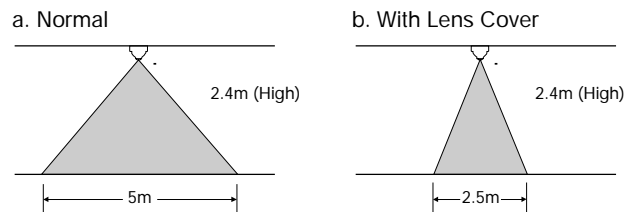

### SPECIFICATIONS

Rated power voltage	110 / 230 VAC, 50/60 Hz
Power consumption	< 80 mA, @ 110 V, no load
Load capacity	1A max.
Switching peak current	30A, 600 $\mu$ S max.
Mounting height	2.2 ~ 2.4 m typical, 3 m max.
Warm up time	Approx. 60 seconds
Detection speed	0.3 ~ 2.5 m/s crossing
Detection range	Ceiling: 5 m dia. @ 2.4m Wall: 10 m, 90° 1.5 ~ 1.8 m
Photocell sensor range	Approx. 1 ~ 2,000 lux
Light-on delay time	Approx. 5 sec. ~ 3 min.
Operating temperature	-10° ~ 65°C
Operating humidity	20 ~ 90% RH
Storage environment	-20° ~ 75 °C, 95% RH max
Dimensions	69 x 55.5 x 32.5 mm